

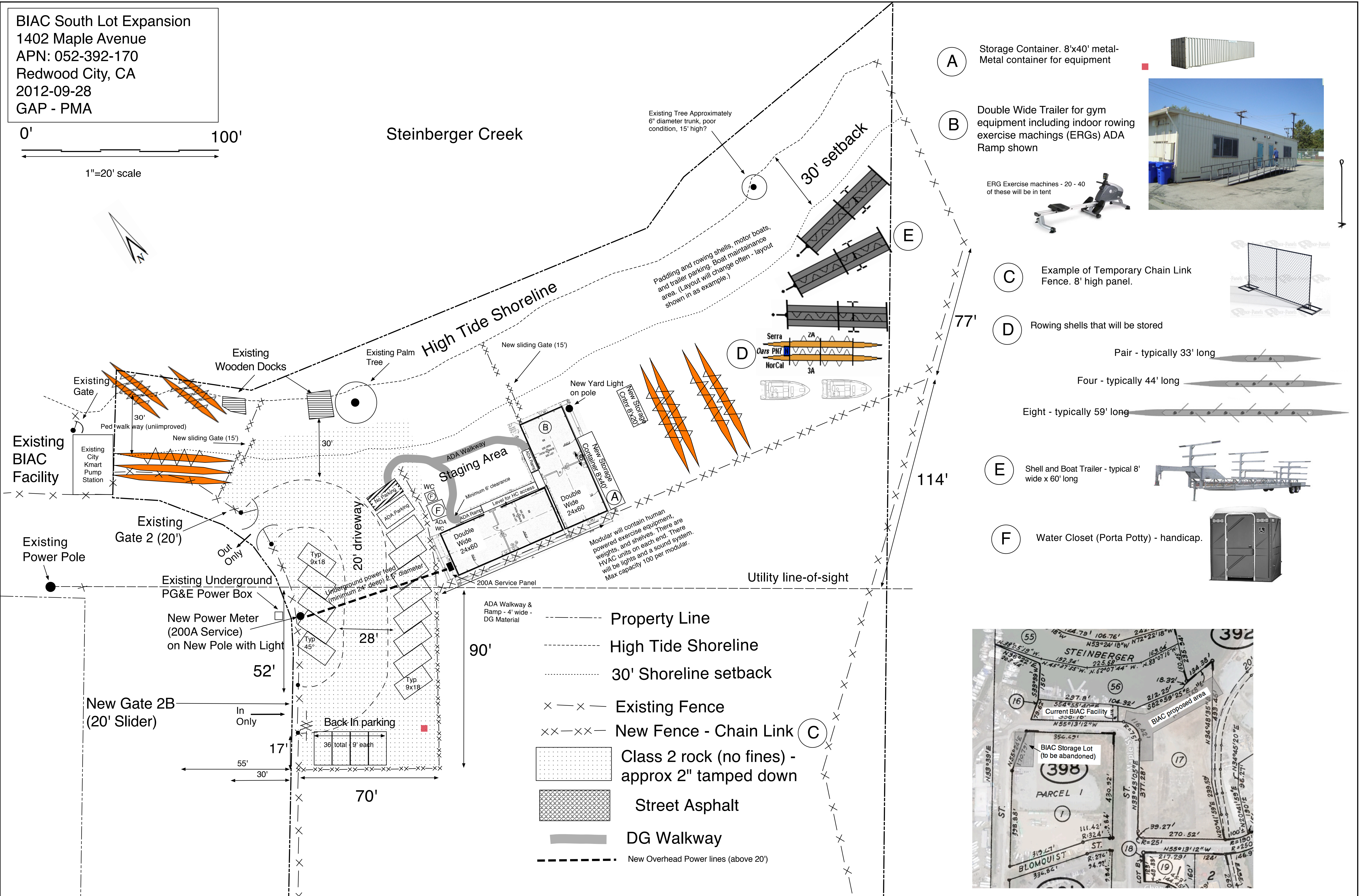





BIAC South Lot Expansion
 1402 Maple Avenue
 APN: 052-392-170
 Redwood City, CA
 2012-09-28
 GAP - PMA

0' 100'
 1"=20' scale

Steinberger Creek

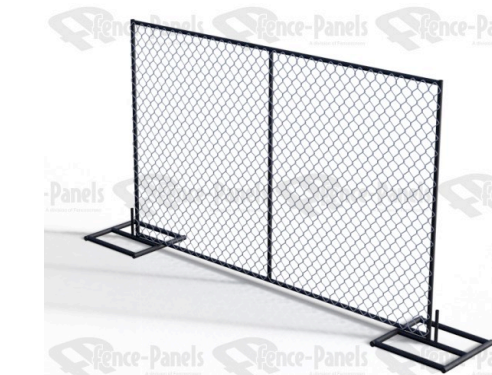
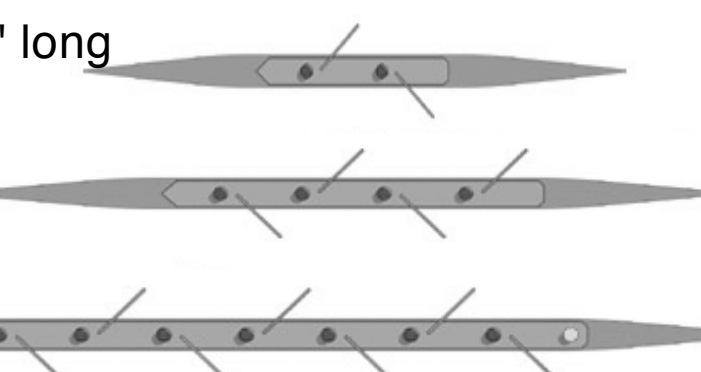

- (A)** Storage Container. 8'x40' metal-Metal container for equipment 
- (B)** Double Wide Trailer for gym equipment including indoor rowing exercise machines (ERGs) ADA Ramp shown 
 ERG Exercise machines - 20 - 40 of these will be in tent 
- (C)** Example of Temporary Chain Link Fence. 8' high panel. 
- (D)** Rowing shells that will be stored 
 Pair - typically 33' long
 Four - typically 44' long
 Eight - typically 59' long
- (E)** Shell and Boat Trailer - typical 8' wide x 60' long 
- (F)** Water Closet (Porta Potty) - handicap. 

- Property Line
- High Tide Shoreline
- 30' Shoreline setback
- × × Existing Fence
- × × × × New Fence - Chain Link (C)
- Class 2 rock (no fines) - approx 2" tamped down
- Street Asphalt
- DG Walkway
- - - - - New Overhead Power lines (above 20')

