

BIAC South Lot Expansion  
 1402 Maple Avenue  
 APN: 052-392-170  
 Redwood City, CA  
 2012-03-23

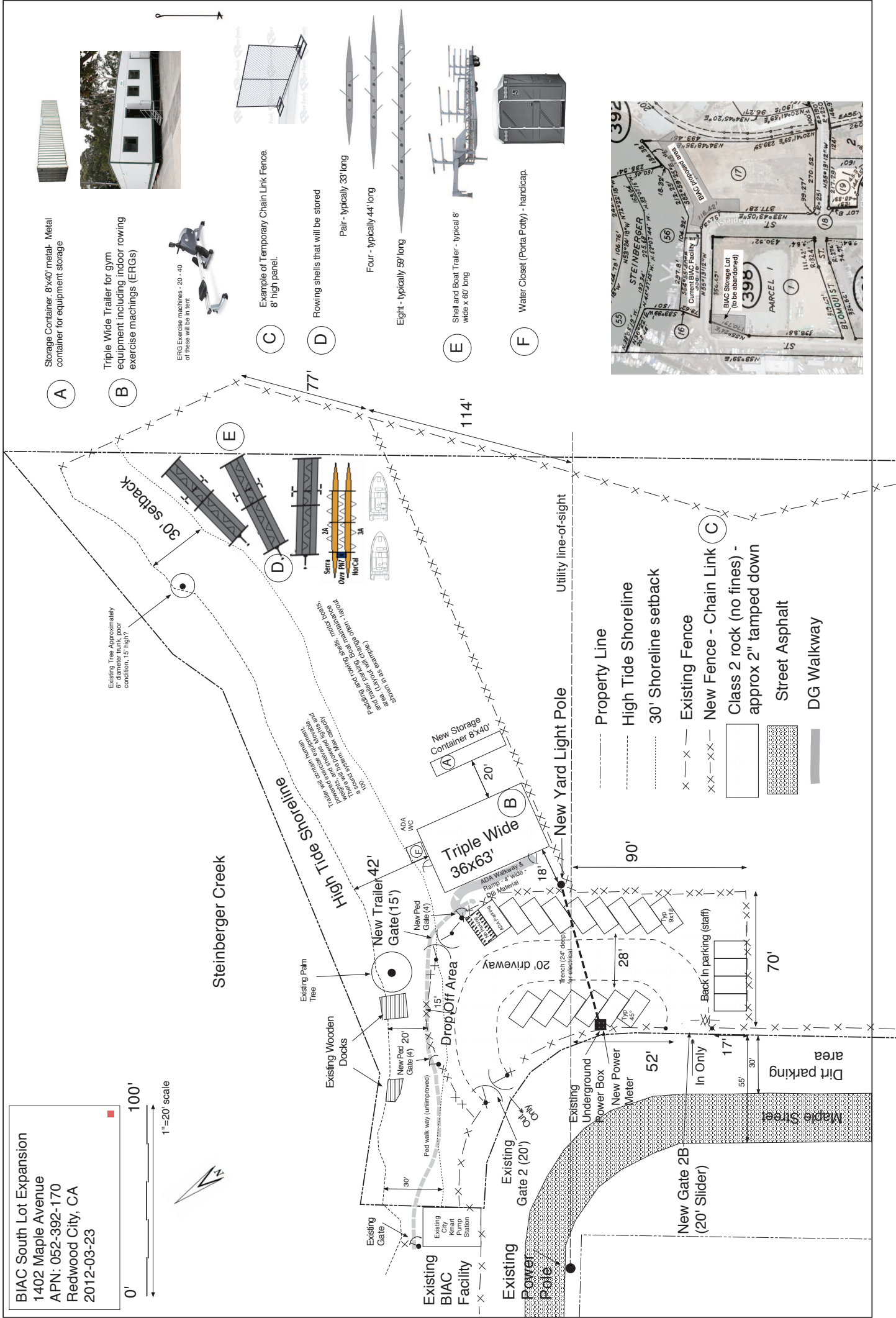

**A** Storage Container, 8'x40' metal. Metal container for equipment storage

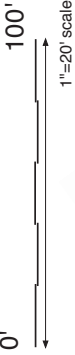

**B** Triple Wide Trailer for gym equipment including indoor rowing exercise machines (ERGs)



ERG Exercise machines - 20 - 40 of these will be in tent

**C** Example of Temporary Chain Link Fence, 8' high panel.

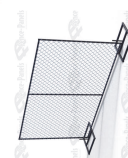

**D** Rowing shells that will be stored

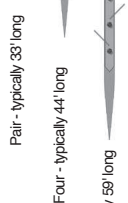

**E** Shell and Boat Trailer - typical 8' wide x 60' long



**F** Water Closet (Porta Potty) - handicap.

